

# Washer faced hex head screws bi-material

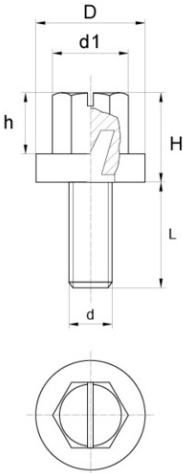

## Details du produit

### Description

It is a question of a zinc-plated steel screw overmolded with a black nylon hexagonal head with a base. The BPF 182 model is, with a slotted hexagonal head, its head is high and narrow. The BPF 180 model has a larger head and a thicker base.

### Advantages

This fully threaded screw offers a base which allows greater contact.

### Qualities

The bi-material side of this screw gives it a longer lifespan.

### usage

These 2 screw models can be used in all areas of activity, but especially for manual use. These 2-screw models are also available in our all-plastic catalog. Please note: The finish of each piece may differ according to the reference chosen. Depending on the mold, the surface may be more or less rough. For pearlescent or metallic colors, streaks and color nuances may appear at the weld line. Illustrations are not contractual.

| d  | D    | h   | H   | L    | S  | Minimum sales Quantity | SKU          |
|----|------|-----|-----|------|----|------------------------|--------------|
| M4 | 14,0 | 5,0 | 8,0 | 10,0 | 10 | 5000                   | BPF180410BAZ |
| M4 | 14,0 | 5,0 | 8,0 | 12,0 | 10 | 5000                   | BPF180412BAZ |
| M4 | 14,0 | 5,0 | 8,0 | 16,0 | 10 | 5000                   | BPF180416BAZ |
| M4 | 14,0 | 5,0 | 8,0 | 18,0 | 10 | 5000                   | BPF180418BAZ |
| M4 | 14,0 | 5,0 | 8,0 | 20,0 | 10 | 5000                   | BPF180420BAZ |
| M4 | 14,0 | 5,0 | 8,0 | 8,0  | 10 | 5000                   | BPF18048BAZ  |

| d  | D    | h   | H    | L    | S  | Minimum sales Quantity | SKU          |
|----|------|-----|------|------|----|------------------------|--------------|
| M5 | 14,0 | 5,0 | 8,0  | 10,0 | 10 | 5000                   | BPF180510BAZ |
| M5 | 14,0 | 5,0 | 8,0  | 12,0 | 10 | 5000                   | BPF180512BAZ |
| M5 | 14,0 | 5,0 | 8,0  | 16,0 | 10 | 5000                   | BPF180516BAZ |
| M5 | 14,0 | 5,0 | 8,0  | 18,0 | 10 | 5000                   | BPF180518BAZ |
| M5 | 14,0 | 5,0 | 8,0  | 20,0 | 10 | 5000                   | BPF180520BAZ |
| M5 | 14,0 | 5,0 | 8,0  | 25,0 | 10 | 5000                   | BPF180525BAZ |
| M5 | 14,0 | 5,0 | 8,0  | 30,0 | 10 | 5000                   | BPF180530BAZ |
| M5 | 14,0 | 5,0 | 8,0  | 35,0 | 10 | 5000                   | BPF180535BAZ |
| M5 | 14,0 | 5,0 | 8,0  | 40,0 | 10 | 5000                   | BPF180540BAZ |
| M6 | 14,0 | 5,0 | 8,0  | 10,0 | 10 | 5000                   | BPF180610BAZ |
| M6 | 14,0 | 5,0 | 8,0  | 12,0 | 10 | 5000                   | BPF180612BAZ |
| M6 | 14,0 | 5,0 | 8,0  | 16,0 | 10 | 5000                   | BPF180616BAZ |
| M6 | 14,0 | 5,0 | 8,0  | 18,0 | 10 | 5000                   | BPF180618BAZ |
| M6 | 14,0 | 5,0 | 8,0  | 20,0 | 10 | 5000                   | BPF180620BAZ |
| M6 | 14,0 | 5,0 | 8,0  | 25,0 | 10 | 5000                   | BPF180625BAZ |
| M6 | 14,0 | 5,0 | 8,0  | 30,0 | 10 | 5000                   | BPF180630BAZ |
| M6 | 14,0 | 5,0 | 8,0  | 35,0 | 10 | 5000                   | BPF180635BAZ |
| M6 | 14,0 | 5,0 | 8,0  | 40,0 | 10 | 5000                   | BPF180640BAZ |
| M4 | 13,0 | 8,0 | 12,0 | 10,0 | 10 | 5000                   | BPF182410BAZ |
| M4 | 13,0 | 8,0 | 12,0 | 12,0 | 10 | 5000                   | BPF182412BAZ |
| M4 | 13,0 | 8,0 | 12,0 | 16,0 | 10 | 5000                   | BPF182416BAZ |

| d  | D    | h   | H    | L    | S  | Minimum sales Quantity | SKU          |
|----|------|-----|------|------|----|------------------------|--------------|
| M4 | 13,0 | 8,0 | 12,0 | 20,0 | 10 | 5000                   | BPF182420BAZ |
| M4 | 13,0 | 8,0 | 12,0 | 25,0 | 10 | 5000                   | BPF182425BAZ |
| M4 | 13,0 | 8,0 | 12,0 | 30,0 | 10 | 5000                   | BPF182430BAZ |
| M4 | 13,0 | 8,0 | 12,0 | 8,0  | 10 | 5000                   | BPF18248BAZ  |
| M5 | 13,0 | 8,0 | 12,0 | 10,0 | 10 | 5000                   | BPF182510BAZ |
| M5 | 13,0 | 8,0 | 12,0 | 12,0 | 10 | 5000                   | BPF182512BAZ |
| M5 | 13,0 | 8,0 | 12,0 | 16,0 | 10 | 5000                   | BPF182516BAZ |
| M5 | 13,0 | 8,0 | 12,0 | 18,0 | 10 | 5000                   | BPF182518BAZ |
| M5 | 13,0 | 8,0 | 12,0 | 20,0 | 10 | 5000                   | BPF182520BAZ |
| M5 | 13,0 | 8,0 | 12,0 | 25,0 | 10 | 5000                   | BPF182525BAZ |
| M5 | 13,0 | 8,0 | 12,0 | 30,0 | 10 | 5000                   | BPF182530BAZ |



**Bülte England**  
37B Basepoint Centre Harts Farm Way Havant Hampshire PO9 1HS