

Washers ~ DIN 1440

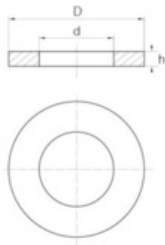

Details du produit

Description

This is a flat washer that approximates the DIN 1440 or ISO 8738 standard. These polyamide washers distribute the pressure of a fastening head evenly over a surface. They ensure that the load or tension is maintained in the assemblies. They also prevent corrosion between the screw and the surface.

usage

They can be used in combination with screws, bolts or studs. They are usually used for joint pins to connect dependent moving parts.

d	D	h	M	Minimum sales Quantity	SKU
10,2	20,0	2,5	10	1000	144010A
12,5	25,0	3,0	12	1000	144012A
16,0	28,0	3,0	16	1000	144016A
3,0	6,0	0,8	3	1000	14403A
4,0	8,0	0,8	4	1000	14404A
5,2	10,0	0,8	5	1000	14405A
6,0	12,0	1,5	6	1000	14406A

d	D	h	M	Minimum sales Quantity	SKU
8,0	16,0	2,0	8	1000	14408A



Bülte England
37B Basepoint Centre Harts Farm Way Havant Hampshire PO9 1HS