

Tornillos de mariposa PLAS 31

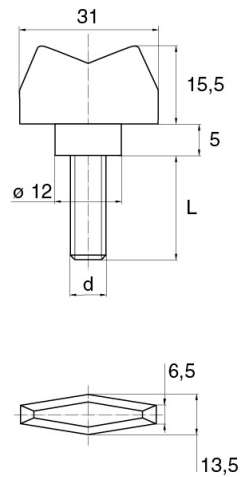

Detalles de producto

Descripción

Este tornillo de mariposa puede atornillarse a mano, de modo que permite fijar dos elementos entre sí en lugares de difícil acceso para las herramientas.

Gracias a su material de fabricación, este tornillo es aislante.

Beneficios

Es aislante, anticorrosión y resistente.

Utilización

Suelen emplearse en la industria, la aeronáutica, etc.

A	B	d	dI	D	h	H	L	Cantidad mínima de venta	Artículo
6,5	13,5	M10	12,0	31,0	5,0	15,5	10,0	5000	PLAS311010A
6,5	13,5	M10	12,0	31,0	5,0	15,5	12,0	5000	PLAS311012A
6,5	13,5	M10	12,0	31,0	5,0	15,5	1,0	5000	PLAS311016A
6,5	13,5	M10	12,0	31,0	5,0	15,5	20,0	5000	PLAS311020A
6,5	13,5	M10	12,0	31,0	5,0	15,5	25,0	5000	PLAS311025A
6,5	13,5	M10	12,0	31,0	5,0	15,5	30,0	5000	PLAS311030A
6,5	13,5	M10	12,0	31,0	5,0	15,5	35,0	5000	PLAS311035A
6,5	13,5	M10	12,0	31,0	5,0	15,5	40,0	5000	PLAS311040A

A	B	d	dI	D	h	H	L	Cantidad mínima de venta	Artículo
6,5	13,5	M10	12,0	31,0	5,0	15,5	45,0	5000	PLAS311045A
6,5	13,5	M10	12,0	31,0	5,0	15,5	50,0	5000	PLAS311050A
6,5	13,5	M10	12,0	31,0	5,0	15,5	60,0	5000	PLAS311060A
6,5	13,5	M10	12,0	31,0	5,0	15,5	6,0	5000	PLAS31106A
6,5	13,5	M10	12,0	31,0	5,0	15,5	70,0	5000	PLAS311070A
6,5	13,5	M10	12,0	31,0	5,0	15,5	80,0	5000	PLAS311080A
6,5	13,5	M10	12,0	31,0	5,0	15,5	8,0	5000	PLAS31108A
6,5	13,5	M5	12,0	31,0	5,0	15,5	10,0	5000	PLAS31510A
6,5	13,5	M5	12,0	31,0	5,0	15,5	12,0	5000	PLAS31512A
6,5	13,5	M5	12,0	31,0	5,0	15,5	16,0	5000	PLAS31516A
6,5	13,5	M5	12,0	31,0	5,0	15,5	20,0	5000	PLAS31520A
6,5	13,5	M5	12,0	31,0	5,0	15,5	25,0	5000	PLAS31525A
6,5	13,5	M5	12,0	31,0	5,0	15,5	30,0	5000	PLAS31530A
6,5	13,5	M5	12,0	31,0	5,0	15,5	35,0	5000	PLAS31535A
6,5	13,5	M5	12,0	31,0	5,0	15,5	40,0	5000	PLAS31540A
6,5	13,5	M5	12,0	31,0	5,0	15,5	6,0	5000	PLAS3156A
6,5	13,5	M5	12,0	31,0	5,0	15,5	8,0	5000	PLAS3158A
6,5	13,5	M6	12,0	31,0	5,0	15,5	10,0	5000	PLAS31610A
6,5	13,5	M6	12,0	31,0	5,0	15,5	12,0	5000	PLAS31612A
6,5	13,5	M6	12,0	31,0	5,0	15,5	16,0	5000	PLAS31616A
6,5	13,5	M6	12,0	31,0	5,0	15,5	20,0	5000	PLAS31620A

A	B	d	dI	D	h	H	L	Cantidad mínima de venta	Artículo
6,5	13,5	M6	12,0	31,0	5,0	15,5	25,0	5000	PLAS31625A
6,5	13,5	M6	12,0	31,0	5,0	15,5	30,0	5000	PLAS31630A
6,5	13,5	M6	12,0	31,0	5,0	15,5	35,0	5000	PLAS31635A
6,5	13,5	M6	12,0	31,0	5,0	15,5	40,0	5000	PLAS31640A
6,5	13,5	M6	12,0	31,0	5,0	15,5	45,0	5000	PLAS31645A
6,5	13,5	M6	12,0	31,0	5,0	15,5	50,0	5000	PLAS31650A
6,5	13,5	M6	12,0	31,0	5,0	15,5	6,0	5000	PLAS3166A
6,5	13,5	M6	12,0	31,0	5,0	15,5	8,0	5000	PLAS3168A
6,5	13,5	M8	12,0	31,0	5,0	15,5	10,0	5000	PLAS31810A
6,5	13,5	M8	12,0	31,0	5,0	15,5	12,0	5000	PLAS31812A
6,5	13,5	M8	12,0	31,0	5,0	15,5	16,0	5000	PLAS31816A
6,5	13,5	M8	12,0	31,0	5,0	15,5	20,0	5000	PLAS31820A
6,5	13,5	M8	12,0	31,0	5,0	15,5	25,0	5000	PLAS31825A
6,5	13,5	M8	12,0	31,0	5,0	15,5	30,0	5000	PLAS31830A
6,5	13,5	M8	12,0	31,0	5,0	15,5	35,0	5000	PLAS31835A
6,5	13,5	M8	12,0	31,0	5,0	15,5	40,0	5000	PLAS31840A
6,5	13,5	M8	12,0	31,0	5,0	15,5	45,0	5000	PLAS31845A
6,5	13,5	M8	12,0	31,0	5,0	15,5	50,0	5000	PLAS31850A
6,5	13,5	M8	12,0	31,0	5,0	15,5	60,0	5000	PLAS31860A
6,5	13,5	M8	12,0	31,0	5,0	15,5	6,0	5000	PLAS3186A
6,5	13,5	M8	12,0	31,0	5,0	15,5	8,0	5000	PLAS3188A



Bülte Plastiques France

Z.A. de Morlon Portes lès Valence 26 800