

Viti ad ala rettangolari

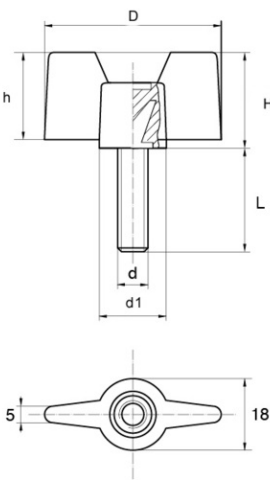

Dettagli del prodotto

Descrizione

Si tratta di viti ad alette rettangolari bi-materiale che sono dotate di una filettatura metrica totale. Si tratta del modello BPF 60.

Vantaggi

Ampiamente usate come manopola di serraggio, queste viti bi-materiale Nylon nero/acciaio zincato sono robuste, rigide e possono essere serrate e (più spesso) allentate a mano, senza attrezzo.

Qualità

Queste viti hanno un design ergonomico grazie alle loro ali rettangolari.

Utilizzo

Queste viti possono essere usate in qualsiasi settore industriale.

A	B	d	d1	D	h	H	L	Quantità minima di vendita	Articolo
5,0	18,0	M5	15,0	41,0	20,0	22,0	10,0	5000	BPF60510BAZ
5,0	18,0	M5	15,0	41,0	20,0	22,0	12,0	5000	BPF60512BAZ
5,0	18,0	M5	15,0	41,0	20,0	22,0	16,0	5000	BPF60516BAZ
5,0	18,0	M5	15,0	41,0	20,0	22,0	20,0	5000	BPF60520BAZ
5,0	18,0	M5	15,0	41,0	20,0	22,0	25,0	5000	BPF60525BAZ
5,0	18,0	M5	15,0	41,0	20,0	22,0	30,0	5000	BPF60530BAZ
5,0	18,0	M5	15,0	41,0	20,0	22,0	35,0	5000	BPF60535BAZ
5,0	18,0	M5	15,0	41,0	20,0	22,0	40,0	5000	BPF60540BAZ

A	B	d	dI	D	h	H	L	Quantità minima di vendita	Articolo
5,0	18,0	M6	15,0	41,0	20,0	22,0	10,0	5000	BPF60610BAZ
5,0	18,0	M6	15,0	41,0	20,0	22,0	12,0	5000	BPF60612BAZ
5,0	18,0	M6	15,0	41,0	20,0	22,0	16,0	5000	BPF60616BAZ
5,0	18,0	M6	15,0	41,0	20,0	22,0	20,0	5000	BPF60620BAZ
5,0	18,0	M6	15,0	41,0	20,0	22,0	25,0	5000	BPF60625BAZ
5,0	18,0	M6	15,0	41,0	20,0	22,0	30,0	5000	BPF60630BAZ
5,0	18,0	M6	15,0	41,0	20,0	22,0	35,0	5000	BPF60635BAZ
5,0	18,0	M6	15,0	41,0	20,0	22,0	40,0	5000	BPF60640BAZ
5,0	18,0	M6	15,0	41,0	20,0	22,0	45,0	5000	BPF60645BAZ
5,0	18,0	M6	15,0	41,0	20,0	22,0	50,0	5000	BPF60650BAZ
5,0	18,0	M8	15,0	41,0	20,0	22,0	16,0	5000	BPF60816BAZ
5,0	18,0	M8	15,0	41,0	20,0	22,0	20,0	5000	BPF60820BAZ
5,0	18,0	M8	15,0	41,0	20,0	22,0	25,0	5000	BPF60825BAZ
5,0	18,0	M8	15,0	41,0	20,0	22,0	30,0	5000	BPF60830BAZ
5,0	18,0	M8	15,0	41,0	20,0	22,0	35,0	5000	BPF60835BAZ
5,0	18,0	M8	15,0	41,0	20,0	22,0	40,0	5000	BPF60840BAZ
5,0	18,0	M8	15,0	41,0	20,0	22,0	45,0	5000	BPF60845BAZ
5,0	18,0	M8	15,0	41,0	20,0	22,0	50,0	5000	BPF60850BAZ



