

Wing grip with large fins (male)

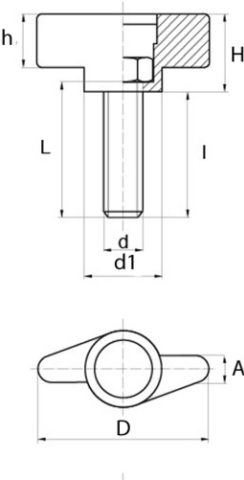

Details du produit

Description

This large wing style fastener with a wing span of 68mm, is ideal for higher torque manual fastening applications.

Advantages

Available in four thread sizes m5, m6, m8 and m10

Qualities

Wing fasteners are widely used through out industrial assembly operations where manual frequent use fastening/unfastening is required.

usage

Use for clamping and locking applications where frequent use is required.

| A | d | d1 | D | h | H | I | L | Minimum sales Quantity | SKU |
|-----|-----|------|------|------|------|------|------|------------------------|---------------|
| 5,0 | M10 | 21,0 | 68,0 | 13,0 | 25,0 | 11,0 | 16,0 | 100 | BPF2581016BAZ |
| 5,0 | M10 | 21,0 | 68,0 | 13,0 | 25,0 | 15,0 | 20,0 | 100 | BPF2581020BAZ |
| 5,0 | M10 | 21,0 | 68,0 | 13,0 | 25,0 | 20,0 | 25,0 | 100 | BPF2581025BAZ |
| 5,0 | M10 | 21,0 | 68,0 | 13,0 | 25,0 | 25,0 | 30,0 | 100 | BPF2581030BAZ |
| 5,0 | M10 | 21,0 | 68,0 | 13,0 | 25,0 | 30,0 | 35,0 | 100 | BPF2581035BAZ |
| 5,0 | M10 | 21,0 | 68,0 | 13,0 | 25,0 | 35,0 | 40,0 | 100 | BPF2581040BAZ |
| 5,0 | M10 | 21,0 | 68,0 | 13,0 | 25,0 | 40,0 | 45,0 | 100 | BPF2581045BAZ |
| 5,0 | M10 | 21,0 | 68,0 | 13,0 | 25,0 | 45,0 | 50,0 | 100 | BPF2581050BAZ |

| A | d | dI | D | h | H | I | L | Minimum sales Quantity | SKU |
|-----|-----|------|------|------|------|------|------|------------------------|---------------|
| 5,0 | M10 | 21,0 | 68,0 | 13,0 | 25,0 | 55,0 | 60,0 | 100 | BPF2581060BAZ |
| 5,0 | M10 | 21,0 | 68,0 | 13,0 | 25,0 | 65,0 | 70,0 | 100 | BPF2581070BAZ |
| 5,0 | M10 | 21,0 | 68,0 | 13,0 | 25,0 | 75,0 | 80,0 | 100 | BPF2581080BAZ |
| 5,0 | M5 | 21,0 | 68,0 | 13,0 | 25,0 | 5,0 | 10,0 | 100 | BPF258510BAZ |
| 5,0 | M5 | 21,0 | 68,0 | 13,0 | 25,0 | 7,0 | 12,0 | 100 | BPF258512BAZ |
| 5,0 | M5 | 21,0 | 68,0 | 13,0 | 25,0 | 11,0 | 16,0 | 100 | BPF258516BAZ |
| 5,0 | M5 | 21,0 | 68,0 | 13,0 | 25,0 | 15,0 | 20,0 | 100 | BPF258520BAZ |
| 5,0 | M5 | 21,0 | 68,0 | 13,0 | 25,0 | 20,0 | 25,0 | 100 | BPF258525BAZ |
| 5,0 | M5 | 21,0 | 68,0 | 13,0 | 25,0 | 25,0 | 30,0 | 100 | BPF258530BAZ |
| 5,0 | M5 | 21,0 | 68,0 | 13,0 | 25,0 | 30,0 | 35,0 | 100 | BPF258535BAZ |
| 5,0 | M5 | 21,0 | 68,0 | 13,0 | 25,0 | 35,0 | 40,0 | 100 | BPF258540BAZ |
| 5,0 | M5 | 21,0 | 68,0 | 13,0 | 25,0 | 40,0 | 45,0 | 100 | BPF258545BAZ |
| 5,0 | M5 | 21,0 | 68,0 | 13,0 | 25,0 | 45,0 | 50,0 | 100 | BPF258550BAZ |
| 5,0 | M5 | 21,0 | 68,0 | 13,0 | 25,0 | 55,0 | 60,0 | 100 | BPF258560BAZ |
| 5,0 | M5 | 21,0 | 68,0 | 13,0 | 25,0 | 65,0 | 70,0 | 100 | BPF258570BAZ |
| 5,0 | M6 | 21,0 | 68,0 | 13,0 | 25,0 | 5,0 | 10,0 | 100 | BPF258610BAZ |
| 5,0 | M6 | 21,0 | 68,0 | 13,0 | 25,0 | 7,0 | 12,0 | 100 | BPF258612BAZ |
| 5,0 | M6 | 21,0 | 68,0 | 13,0 | 25,0 | 11,0 | 16,0 | 100 | BPF258616BAZ |
| 5,0 | M6 | 21,0 | 68,0 | 13,0 | 25,0 | 15,0 | 20,0 | 100 | BPF258620BAZ |
| 5,0 | M6 | 21,0 | 68,0 | 13,0 | 25,0 | 20,0 | 25,0 | 100 | BPF258625BAZ |
| 5,0 | M6 | 21,0 | 68,0 | 13,0 | 25,0 | 25,0 | 30,0 | 100 | BPF258630BAZ |

| A | d | dI | D | h | H | I | L | Minimum sales Quantity | SKU |
|-----|----|------|------|------|------|------|------|------------------------|--------------|
| 5,0 | M6 | 21,0 | 68,0 | 13,0 | 25,0 | 30,0 | 35,0 | 100 | BPF258635BAZ |
| 5,0 | M6 | 21,0 | 68,0 | 13,0 | 25,0 | 35,0 | 40,0 | 100 | BPF258640BAZ |
| 5,0 | M6 | 21,0 | 68,0 | 13,0 | 25,0 | 40,0 | 45,0 | 100 | BPF258645BAZ |
| 5,0 | M6 | 21,0 | 68,0 | 13,0 | 25,0 | 45,0 | 50,0 | 100 | BPF258650BAZ |
| 5,0 | M6 | 21,0 | 68,0 | 13,0 | 25,0 | 55,0 | 60,0 | 100 | BPF258660BAZ |
| 5,0 | M6 | 21,0 | 68,0 | 13,0 | 25,0 | 65,0 | 70,0 | 100 | BPF258670BAZ |
| 5,0 | M6 | 21,0 | 68,0 | 13,0 | 25,0 | 75,0 | 80,0 | 100 | BPF258680BAZ |
| 5,0 | M8 | 21,0 | 68,0 | 13,0 | 25,0 | 5,0 | 10,0 | 100 | BPF258810BAZ |
| 5,0 | M8 | 21,0 | 68,0 | 13,0 | 25,0 | 7,0 | 12,0 | 100 | BPF258812BAZ |
| 5,0 | M8 | 21,0 | 68,0 | 13,0 | 25,0 | 11,0 | 16,0 | 100 | BPF258816BAZ |
| 5,0 | M8 | 21,0 | 68,0 | 13,0 | 25,0 | 15,0 | 20,0 | 100 | BPF258820BAZ |
| 5,0 | M8 | 21,0 | 68,0 | 13,0 | 25,0 | 20,0 | 25,0 | 100 | BPF258825BAZ |
| 5,0 | M8 | 21,0 | 68,0 | 13,0 | 25,0 | 25,0 | 30,0 | 100 | BPF258830BAZ |
| 5,0 | M8 | 21,0 | 68,0 | 13,0 | 25,0 | 30,0 | 35,0 | 100 | BPF258835BAZ |
| 5,0 | M8 | 21,0 | 68,0 | 13,0 | 25,0 | 35,0 | 40,0 | 100 | BPF258840BAZ |
| 5,0 | M8 | 21,0 | 68,0 | 13,0 | 25,0 | 40,0 | 45,0 | 100 | BPF258845BAZ |
| 5,0 | M8 | 21,0 | 68,0 | 13,0 | 25,0 | 45,0 | 50,0 | 100 | BPF258850BAZ |
| 5,0 | M8 | 21,0 | 68,0 | 13,0 | 25,0 | 55,0 | 60,0 | 100 | BPF258860BAZ |
| 5,0 | M8 | 21,0 | 68,0 | 13,0 | 25,0 | 65,0 | 70,0 | 100 | BPF258870BAZ |





e Harts Farm Way Havant Hampshire PO9 1HS