

## Flanged knurled handwheel BPF 640 (male)

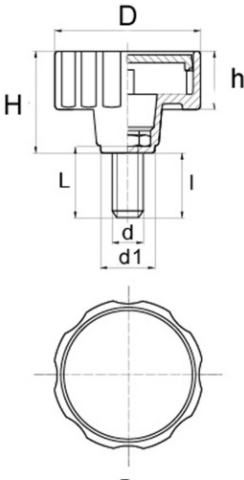

### Details du produit

#### Description

An alternative style of round knob for heavier duty applications. BPF640 has a diameter of 64mm and is available in m8, m10 and m12.

#### Advantages

The head is manufactured in black Polyamide and is resistant to grease and oils, and are hard wearing.

#### Qualities

Manufactured in black polyamide for durability, combined with either Brass, Nylon, Zinc plated steel or Stainless steel A2 threads.

#### usage

Designed for heavier duty applications where hand fastening is desired.

d	d1	D	h	H	I	L	Minimum sales Quantity	SKU
M10	24,0	64,0	28,0	45,0	16,0	20,0	100	BPF6401020BAZ
M10	24,0	64,0	28,0	45,0	21,0	25,0	100	BPF6401025BAZ
M10	24,0	64,0	28,0	45,0	26,0	30,0	100	BPF6401030BAZ
M10	24,0	64,0	28,0	45,0	31,0	35,0	100	BPF6401035BAZ
M10	24,0	64,0	28,0	45,0	36,0	40,0	100	BPF6401040BAZ
M10	24,0	64,0	28,0	45,0	41,0	45,0	100	BPF6401045BAZ
M10	24,0	64,0	28,0	45,0	46,0	50,0	100	BPF6401050BAZ
M10	24,0	64,0	28,0	45,0	56,0	60,0	100	BPF6401060BAZ

d	dI	D	h	H	I	L	Minimum sales Quantity	SKU
M12	24,0	64,0	28,0	45,0	16,0	20,0	100	BPF6401220BAZ
M12	24,0	64,0	28,0	45,0	21,0	25,0	100	BPF6401225BAZ
M12	24,0	64,0	28,0	45,0	26,0	30,0	100	BPF6401230BAZ
M12	24,0	64,0	28,0	45,0	31,0	35,0	100	BPF6401235BAZ
M12	24,0	64,0	28,0	45,0	36,0	40,0	100	BPF6401240BAZ
M12	24,0	64,0	28,0	45,0	41,0	45,0	100	BPF6401245BAZ
M12	24,0	64,0	28,0	45,0	46,0	50,0	100	BPF6401250BAZ
M12	24,0	64,0	28,0	45,0	56,0	60,0	100	BPF6401260BAZ
M8	24,0	64,0	28,0	45,0	16,0	20,0	100	BPF640820BAZ
M8	24,0	64,0	28,0	45,0	21,0	25,0	100	BPF640825BAZ
M8	24,0	64,0	28,0	45,0	26,0	30,0	100	BPF640830BAZ
M8	24,0	64,0	28,0	45,0	31,0	35,0	100	BPF640835BAZ
M8	24,0	64,0	28,0	45,0	36,0	40,0	100	BPF640840BAZ
M8	24,0	64,0	28,0	45,0	41,0	45,0	100	BPF640845BAZ
M8	24,0	64,0	28,0	45,0	46,0	50,0	100	BPF640850BAZ
M8	24,0	64,0	28,0	45,0	56,0	60,0	100	BPF640860BAZ



**Bülte England**  
37B Basepoint Centre Harts Farm Way Havant Hampshire PO9 1HS