

Knurled thumb screws PLAS 91

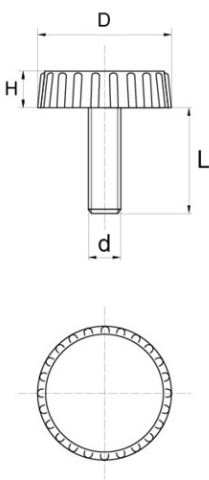

Details du produit

Description

Knurled head screw provides extra grip for advanced tightening. Perfect for securing objects.

Advantages

The PLAS 91 knurled head screw can be screwed in by hand. They are used for applications where the fastener needs to be tightened or loosened by hand, most commonly when something needs to be repeatedly adjusted, re-installed or removed.

Qualities

Knurled thumb screws are designed specifically for ease of use and simplicity.

usage

Knurled thumb screws are most commonly used in: Household applications, Electronics, Consumer products.

d	D	H	L	Minimum sales Quantity	SKU
M10	21,0	8,5	10,0	5000	PLAS911010A
M10	21,0	8,5	12,0	5000	PLAS911012A
M10	21,0	8,5	15,0	10000	PLAS911015/10A
M10	21,0	8,5	16,0	5000	PLAS911016A
M10	21,0	8,5	17,0	10000	PLAS911017/12A
M10	21,0	8,5	20,0	5000	PLAS911020A
M10	21,0	8,5	25,0	5000	PLAS911025A

d	D	H	L	Minimum sales Quantity	SKU
M10	21,0	8,5	30,0	5000	PLAS911030A
M10	21,0	8,5	35,0	5000	PLAS911035A
M10	21,0	8,5	40,0	5000	PLAS911040A
M10	21,0	8,5	45,0	5000	PLAS911045A
M10	21,0	8,5	50,0	5000	PLAS911050A
M10	21,0	8,5	60,0	5000	PLAS911060A
M10	21,0	8,5	6,0	5000	PLAS91106A
M10	21,0	8,5	70,0	5000	PLAS911070A
M10	21,0	8,5	80,0	5000	PLAS911080A
M10	21,0	8,5	8,0	5000	PLAS91108A
M12	21,0	8,5	10,0	2500	PLAS911210A
M12	21,0	8,5	12,0	2500	PLAS911212A
M12	21,0	8,5	16,0	2500	PLAS911216A
M12	21,0	8,5	20,0	2500	PLAS911220A
M12	21,0	8,5	25,0	2500	PLAS911225A
M12	21,0	8,5	30,0	2500	PLAS911230A
M12	21,0	8,5	35,0	2500	PLAS911235A
M12	21,0	8,5	40,0	2500	PLAS911240A
M12	21,0	8,5	45,0	2500	PLAS911245A
M12	21,0	8,5	50,0	2500	PLAS911250A
M12	21,0	8,5	60,0	2500	PLAS911260A

d	D	H	L	Minimum sales Quantity	SKU
M12	21,0	8,5	70,0	2500	PLAS911270A
M12	21,0	8,5	80,0	2500	PLAS911280A
M8	21,0	8,5	10,0	5000	PLAS91810A
M8	21,0	8,5	12,0	5000	PLAS91812A
M8	21,0	8,5	15,0	10000	PLAS91815/10A
M8	21,0	8,5	16,0	5000	PLAS91816A
M8	21,0	8,5	17,0	10000	PLAS91817/12A
M8	21,0	8,5	20,0	5000	PLAS91820A
M8	21,0	8,5	25,0	5000	PLAS91825A
M8	21,0	8,5	30,0	5000	PLAS91830A
M8	21,0	8,5	35,0	5000	PLAS91835A
M8	21,0	8,5	40,0	5000	PLAS91840A
M8	21,0	8,5	45,0	5000	PLAS91845A
M8	21,0	8,5	20,0	5000	PLAS91850A
M8	21,0	8,5	60,0	5000	PLAS91860A
M8	21,0	8,5	6,0	5000	PLAS9186A
M8	21,0	8,5	8,0	5000	PLAS9188A

